



Studer Professional Audio GmbH,
Riedthofstrasse 214,
CH-8105 Regensdorf,
Switzerland.

Phone: +41 44 870 75 11
Fax: +41 44 870 71 34

Studer reserves the right to improve or otherwise
alter any information supplied in this document or
any documentation supplied hereafter. E&OE 09/13.
All trademarks are recognised as the property of
their respective owners.

Part No: 5042752

Issue: 0114

www.studer.ch



A close-up, angled view of a black, textured speaker grille. The word "STUDER" is embossed in large, capital letters across the center of the grille. The texture of the grille is a fine, repeating diamond pattern.

Broadcast Sound Mixing System



Introducing Vista X. An intuitive new operating surface that controls the Infinity Core – the world's most powerful broadcast sound mixing system.

Core strength

Unprecedented CPU-based processing power

Big productions demand a lot of processing muscle. The new Studer Infinity Core delivers an unprecedented 800+ audio channels with superb sonic quality, and more than 5000 inputs and outputs.

And the use of CPU-based processors suggests exciting possibilities for scaling up to even larger channel counts, and for running third party algorithms.

INFINITYSERIES™



The Studer Infinity Core

Aviation-standard system redundancy

A first in broadcast sound mixing

The new Vista X with Quad Star technology uses four processors to achieve aviation-standard levels of redundancy in the control surface while CPU-based DSP makes it viable to provide two completely independent DSP cores running in parallel with 'instant' change over.

Overcoming the potential single points of failure evident in conventional TDM-based systems assures total peace of mind, and also offers the possibility of two complete Vista X surfaces working on the same project at the same time, enabling very large, dual language or multi-format productions to be undertaken with ease.



Vistonics. FaderGlow.

A revolutionary approach to stress-free mixing

Vista mixing engineers are freed from the burden of complex mental mapping necessitated by the process of digital audio mixing using a central screen. Studer's revolutionary Vistonics™ interface builds Vista X's rotary controls and buttons directly into the flat screen displays which provide visual feedback. Each audio function is always associated with the same colour – red for EQ and filters, green for dynamics, and so on.

Another Studer innovation, FaderGlow™, combines with assignable channel naming to further reduce stress by illuminating each fader in the colour relating to the relevant function, creating an instant overview of console status.



Vistonics. Detailed visual feedback, right where it's needed.



FaderGlow. An instant overview of fader status.

Comprehensive metering

A better view means a better the mix

The Vista X control surface displays everything you need to see in a format you can readily comprehend. There's a large scale bargraph meter for every channel from mono to surround, plus a history display of the last 50 seconds of audio to capture those annoying clicks and overloads so hard to find in a multi-mic live show.



Comprehensive metering on the Vista X control surface.



Loudness metering is built right into the console.



VistaMix

Automated microphone mixing for unscripted panel shows

Essential for live, multi-mic, unscripted events such as talk shows and game shows, VistaMix™ automatically mimics the actions of a highly skilled human operator; increasing gain for 'talking' mics and reducing gain for all others at lightning speed to create a clean live mix without spill or ambience.

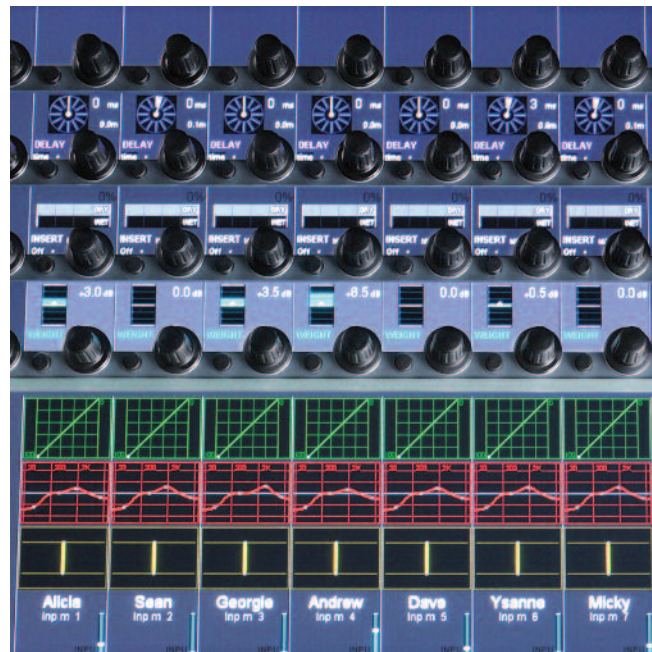

Individual weight controls allow the host to be audible, even in the most demanding of shows.



Seamless integration

Upgrading the mixer shouldn't mean changing the workflow

Studer's AutoTouch Plus Dynamic Automation System allows the most complex automation tasks to be carried out within a clear and logical workflow while EMBER support provides seamless integration with broadcast and newsroom automation systems.

Vista X exists for pain free live production, with dedicated controls for extensive snapshot filtering, buttons for talkback and user-programmable functions, configurable matrix busses, dedicated mute groups and stress free outside source management. Vista X interfaces with all major DAW systems. Many DAW functions can be directly controlled on the console, where innovative operating concepts such as StripSetup and Ganging bring DAW integration to a new level and greatly enhance the production workflow.



Surround sound made easy

Acquire. Manage. Upmix.

Vista X makes it easy to acquire and manage multichannel audio sources while Virtual Surround Panning (VSP II) empowers the operator to take mono sources and create a realistic sound field (stereo up to 7.1) modelled around a few simple parameters.



Key parameters can be adjusted directly via touch on the Vistonics screen without the need to spill single mono or stereo channels to additional faders.



Ultimate I/O flexibility

Because great broadcasting is never simple

The new Infinity Core provides twelve high-capacity Studer A-Link fibre audio interfaces, providing more than 5000 inputs and outputs. Studer's new high density D23m I/O system is used to breakout these A-Link connections to standard analogue, digital and video interfaces. Local and remote I/O frames can be fitted with a wide variety of I/O cards to configure optimised systems for studio-based productions and outside broadcasts.

The A-Link interface also provides direct connection to the industry-standard Riedel MediorNet distributed router allowing many Infinity systems to be connected together with router capacities of 10,000 square or more.

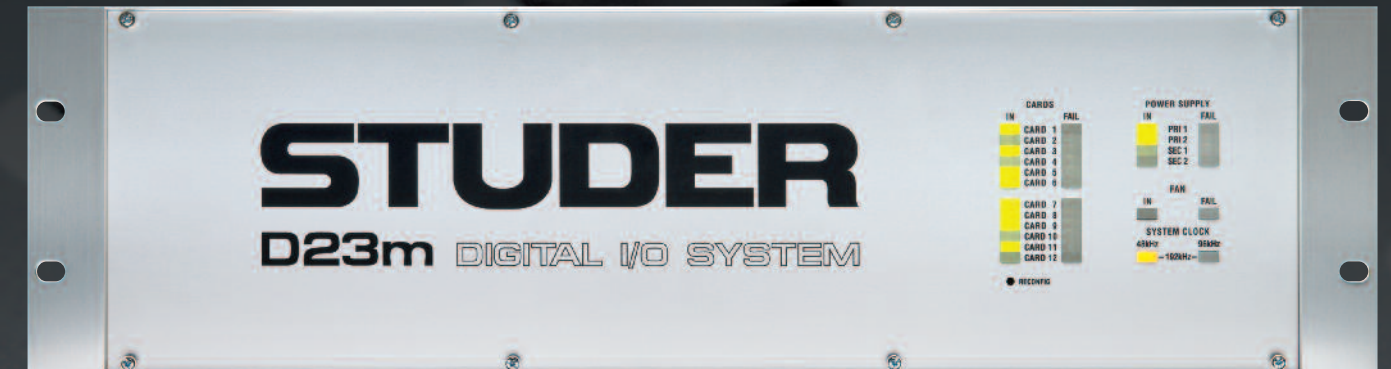

The Studer D23m modular I/O system - front panel

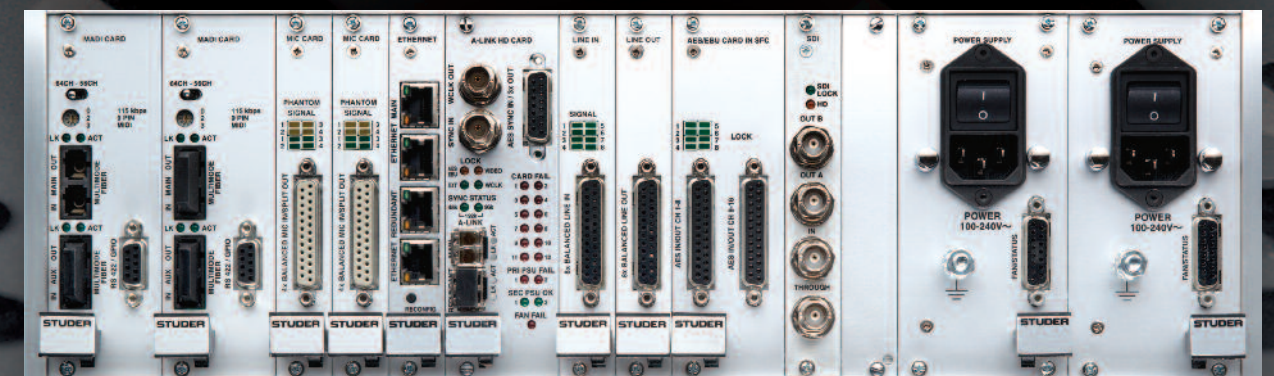

The Studer D23m modular I/O system - rear panel



Riedel MediorNet Modular system

Custom colours and finishes

Create a console to fit your workspace

The Studer Infinity concept of flexible, stress-free broadcast sound mixing extends to a range of optional side panels, arm rests and top bars that let you customise the Vista X control surface to fit the design and colour scheme of your room or truck.

It's even possible to adjust the colour of the metering!

Side panel colour options



Black Metallic



Grey Metallic



Pearl White

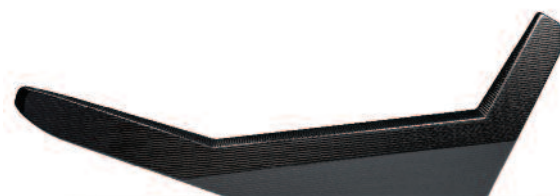

Carbon Fibre*

*Studer logo is not available on the Vista X Carbon Fibre side panel

Floorstand colour options



Dark



Light



Vista X control surface with carbon fibre side panels, black armrest and black top panels.

Meter top panel colour options



Silver Anodized



Black Anodized

Armrest colour options



Petrol



Black



Grey



Anthracite

Dimensions

StuderVista X dimensions

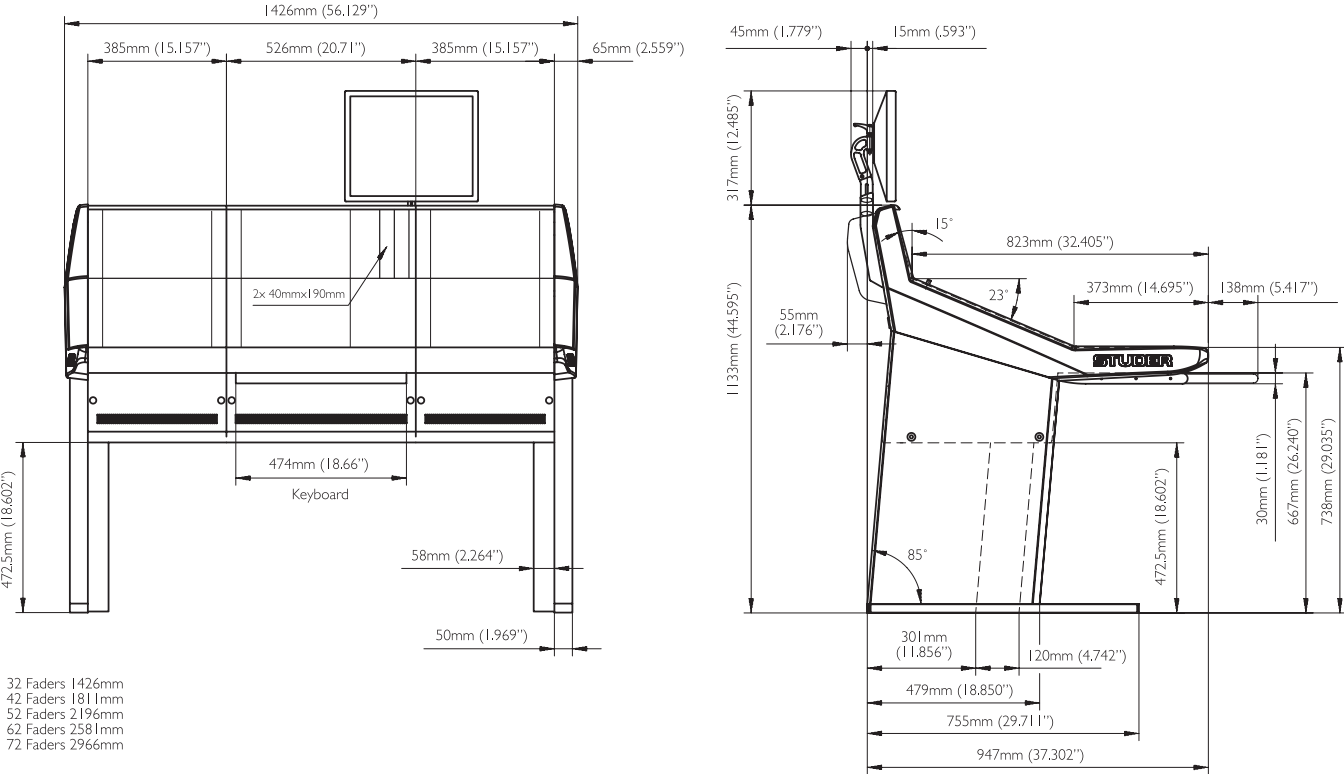

Studer Infinity Core dimensions

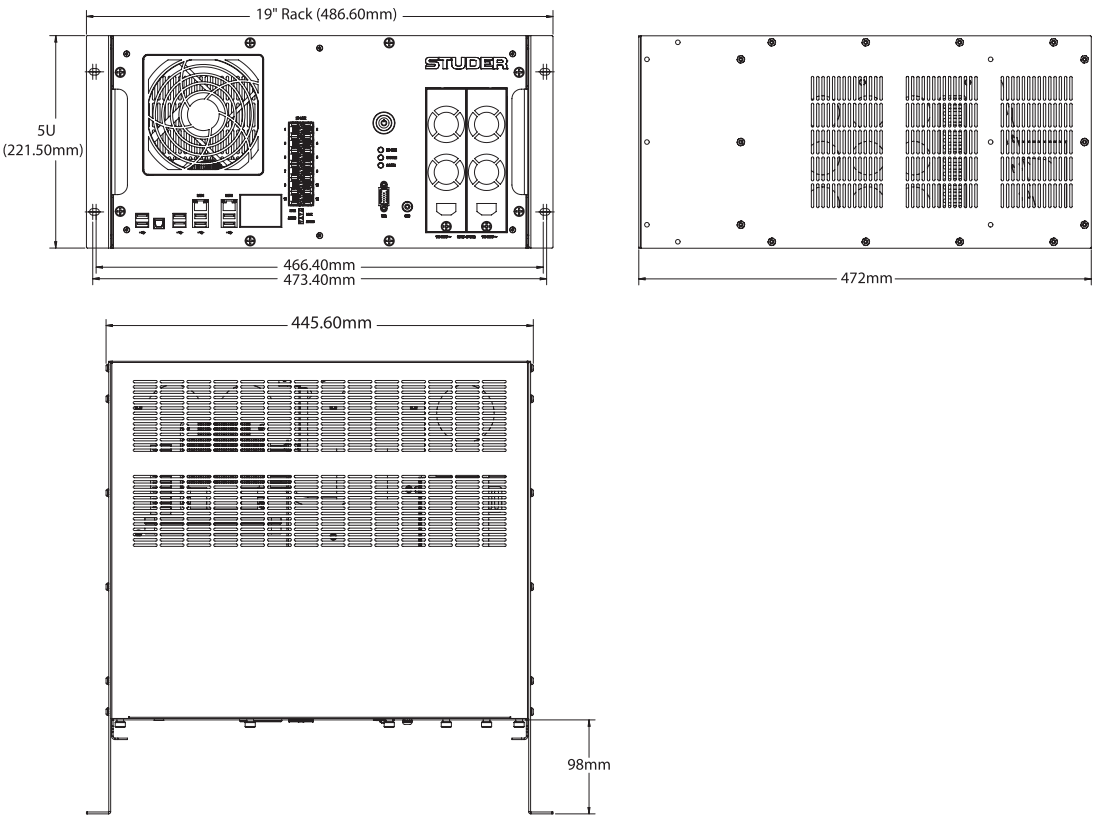

Studer D23m dimensions

